

CONFORMED

Dist	COUNTY	ROUTE	POST MILES TOTAL PROJECT	SHEET No.	TOTAL SHEETS
07	Ven	150	R13.3/19.0	1	311



SHEET No.	DESCRIPTION
1	TITLE AND LOCATION MAP
2	LOCATION OF CONSTRUCTION
3-5	TYPICAL CROSS SECTIONS
6-7	KEY MAP AND LINE INDEX
8	PROJECT CONTROL
9-31	LAYOUTS
32-87	CONSTRUCTION DETAILS
88-113	DRAINAGE PLANS, PROFILES, DETAILS AND QUANTITIES
114-138	UTILITY PLANS
139	CONSTRUCTION AREA SIGNS
140-152	TRAFFIC HANDLING PLANS, DETAILS AND QUANTITIES
153-178	PAVEMENT DELINEATION PLANS, DETAILS AND QUANTITIES
179-229	SIGN PLANS, DETAILS AND QUANTITIES
230-235	SUMMARY OF QUANTITIES
236-250	LANDSCAPE LAYOUT PLAN AND DETAILS
251-271	ELECTRICAL PLANS AND QUANTITIES
272-307	REVISED STANDARD PLANS
308-311	VENDOR DRAWINGS

PROJECT PLANS FOR CONSTRUCTION ON STATE HIGHWAY
IN VENTURA COUNTY
IN AND NEAR OJAI
FROM BURNHAM ROAD TO GORHAM ROAD

TO BE SUPPLEMENTED BY STANDARD PLANS DATED 2018

THE STANDARD PLANS LIST APPLICABLE TO THIS CONTRACT IS INCLUDED IN THE NOTICE TO BIDDERS AND SPECIAL PROVISIONS BOOK.

Reversing Flagging Traffic Control
 S La Luna Ave to El Paseo Rd
 Golden West Ave to Gorham Rd

Lane Pushover Traffic Control
 Burnham Rd to S La Luna Ave
 El Paseo Rd to Golden West Ave
 ***No Street Parking Allowed during Striping

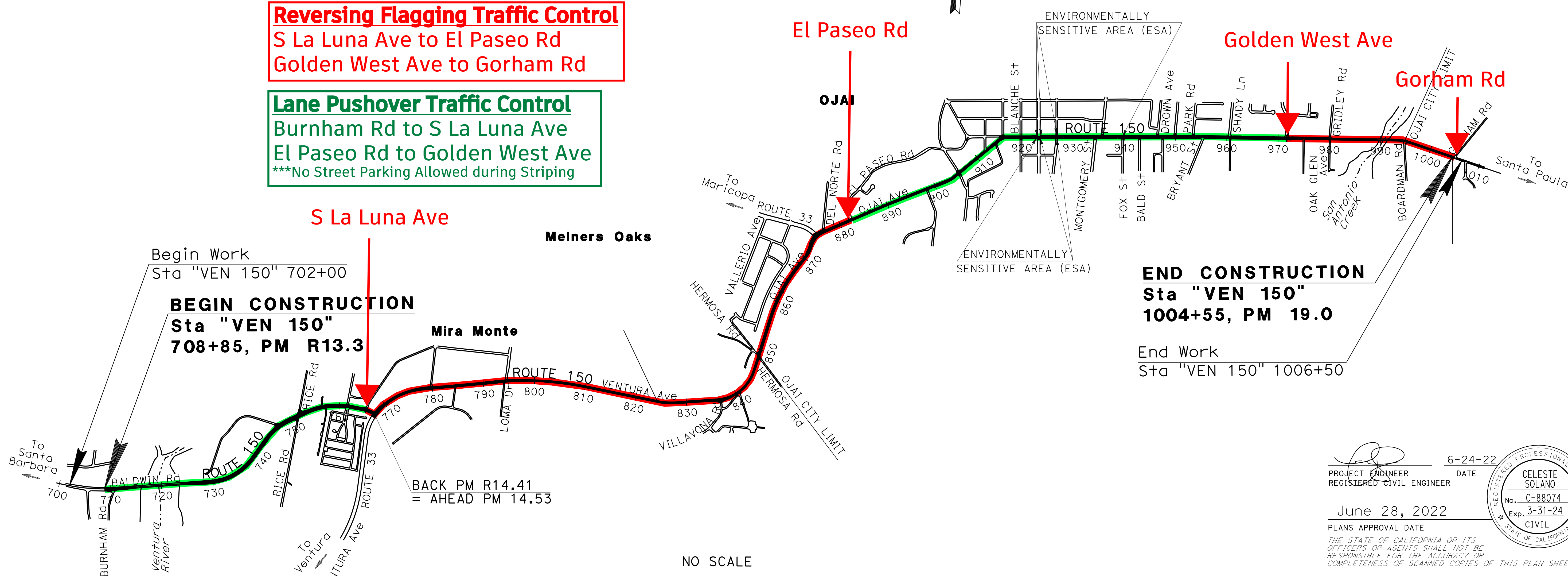

END CONSTRUCTION
 Sta "VEN 150"
 1004+55, PM 19.0

End Work
 Sta "VEN 150" 1006+50

PROJECT MANAGER
JOSEPH KIBE

DESIGN MANAGER
MD ALAM

PROJECT ENGINEER
REGISTERED CIVIL ENGINEER

DATE
6-24-22

June 28, 2022
PLANS APPROVAL DATE

CELESTE SOLANO
No. C-88074
Exp. 3-31-24
CIVIL
STATE OF CALIFORNIA

THE STATE OF CALIFORNIA OR ITS OFFICERS OR AGENTS SHALL NOT BE RESPONSIBLE FOR THE ACCURACY OR COMPLETENESS OF SCANNED COPIES OF THIS PLAN SHEET.

THE CONTRACTOR SHALL POSSESS THE CLASS (OR CLASSES) OF LICENSE AS SPECIFIED IN THE "NOTICE TO BIDDERS."